



ADDENDUM NUMBER ONE

June 21, 2016

**IFB #16-912-24;
SUPPLY AND INSTALLATION OF FURNITURE, FIXTURES AND EQUIPMENT AT
FOUBOURG LAFITTE SENIOR BUILDING**

THIS ADDENDUM IS BEING ISSUED TO INCORPORATE THE FOLLOWING IN THE REFERENCED INVITATION FOR BIDS

**ITEM #1 QUESTIONS ASKED DURING PRE-BID CONFERENCE AND ADDITIONAL
QUESTIONS RECEIVED**

**Q1: IS THERE A CERTAIN PERCENTAGE OF DBE PARTICIPATION OR WBE
PARTICIPATION REQUIRED?**

A1: Pursuant to Part I of the Employment, Training, and Contracting Policy, "This policy applies to all contracts valued at \$100,000 or greater."

**Q2: On C-4 their product number given is incorrect. Also it says "legs" when
I'm pretty sure they mean the SSU "armcaps". Please clarify.**

A2: See Item #3 below.

The legs are to be SSU.

Q3: C-8 the product number is also incorrect.

A3: See Item #3 below

**Q4: In Items S-2 and S-2a of the specifications, there are (5) 30"W lateral
files and only (2) 60"W tops. Please confirm if this is correct.**

A4: This is correct. There are 2 sets of 2 (S-2) filing cabinets that receive S-2a. The fifth S-2 is under the built-in reception desk.

ITEM #2 LICENSING REQUIREMENTS

DELETE: There are no licensing requirements for this project.
Delete all reference to Contractor's License Number in the IFB.

ITEM #3 SPECIFICATIONS

DELETE: Delete pages C-4, and C-8 from the specifications.

INSERT: Insert the revised pages C-4, and C-8, as attached.

DELETE: On sheet 1 of 3, Equipment/Furniture, Back Porch 100B, EC-1, delete the word "Bench".

INSERT: Insert the words "Rocking Chair".

ITEM #4 PRE-BID CONFERENCE SIGN-IN SHEET

See Pre-Bid Conference Sign-In Sheet, as attached.

Bids must be received by the Housing Authority of New Orleans (HANO) in the Department of Procurement and Contracts by 2:00 p.m. CST on Friday, June 24, 2016. All terms and conditions shall remain as stated in the original Invitation for Bids. All addenda must be acknowledged.

END OF ADDENDUM NUMBER ONE

Group:	Chair
Item Number:	C-4
Manufacturer:	Globalcare
Series:	Primacare Lounge Chair
Mfg. Number:	GC3679
Dimensions:	22D x 22W x 17H
Description:	Bariatric lounge chair, low back, fully upholstered arms with SSU legs, upholstered seat and back, for users up to 500lbs, single fabric upholstered selection, grade 9 fabric, moisture barrier (seat only), 3.5" high density ultracell foam at seat and back, metal mesh seat deck, Replaceable seat covers and replaceable and/or removable seat cushions, armcaps are securely fastened with metal to metal connector which allow for field replacement

Finishes:	
Manufacturer:	Maharam
Finish:	Chime
Seat and Back	Chime, color: Morel
Armpad	Primacare Wood: Shaker Cherry
Base and Frame	Chime, color: Morel
Legs	SSU, Toast

Location:	Room Name	Room Number	Quantity
	Activity Room	198	1
	Storage	358	1

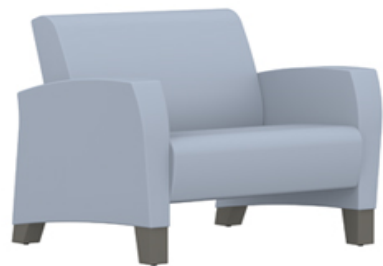

Group:	Chair
Item Number:	C-8
Manufacturer:	Globalcare
Series:	Desmond
Mfg. Number:	GC4162
Dimensions:	24W x 22.5D x 36H; seat: 22.5W x 18D x 17.5H; back: 17.5W x 18.5H
Description:	Dining armchair with solid wood frame, upholstered seat and back, arm with grip extension, additional support rail on legs, moisture barrier (seat only), grade 8 fabric
Finishes:	

Manufacturer:	Maharam
Finish:	Lineage
Seat and Back	Lineage, color: Merchant
Armpad	Primacare Wood: Shaker Cherry
Base and Frame	Primacare Wood: Shaker Cherry

Location:	Room Name	Room Number	Quantity
	Manager's Office	162	4
	Elevator Lobby	260	2
	Elevator Lobby	360	2





HOUSING AUTHORITY OF NEW ORLEANS
 PRE-BID CONFERENCE
 FOR
 SUPPLY AND INSTALLATION OF FURNITURE, FIXTURES AND EQUIPMENT
 AT THE FAUBOURG LAFITTE SENIOR BUILDING

Thursday, June 16, 2016
 2:00 P.M.

SIGN-IN SHEET

NAME/REPRESENTATIVE	COMPANY NAME	PHONE	EMAIL	DBE/WBE CERTIFIED	
				Yes	No
Allison Waper-Chalmers	Blich Knevel Architects	504-524-4034	allison@blitchknevel.com		
Ashley Herbert	Bart's Office Inc	504-669-8534	ashley@barts-office.com	✓	
Vedra. e moten	Bart's office inc	504 684-4644	Vedra e @ barts-office	✓	
Shawne Wiltz-Humley	HANO	670-3249	DWILTZ@HANO.ORG	N/A	
Monica Eady	AOS	491-1551	M.eady@thinkaos.com		
Suzanne Dumez	AOS	561-8400	S.dumez@thinkaos.com		✓



HOUSING AUTHORITY OF NEW ORLEANS
 PRE-BID CONFERENCE
 FOR
 SUPPLY AND INSTALLATION OF FURNITURE, FIXTURES AND EQUIPMENT
 AT THE FAUBOURG LAFITTE SENIOR BUILDING

Thursday, June 16, 2016
 2:00 P.M.

SIGN-IN SHEET

NAME/REPRESENTATIVE	COMPANY NAME	PHONE	EMAIL	DBE/WBE CERTIFIED	
				Yes	No
TERRI NORTH	Providence Comm. Housing	504-821-7221	tnorth@providencech.org	/	
Veronica Douget	Workplace Resource	504-495-8154	Veronica.Douget@wrstx.com		
Matt Morrin	Enterprise / Lafitte Senior Housing	504-835-2309	mmorrin@enterprisehomes.com		
Michael Lavis	GBP Direct ASR	504-508-5566	mlavis@GBP Direct.com		
Jennifer Adams	HANO	504 670 3267			
Wade Reynolds	HANO	504 373 8747	wreynold@hano.org		